

SEATING AREA

Rock Yard Restaurant has two seated dining areas and one waiting area (the yard):

- The dining room: main room & mezzanine floor

Seated Capacity	The main room	The Mezzanine
	62 guests	20 guests

- The yard area: featured with barstools & bar leaners. Can be seated for 10 people max. It is an excellent area for welcome drink & canapé.

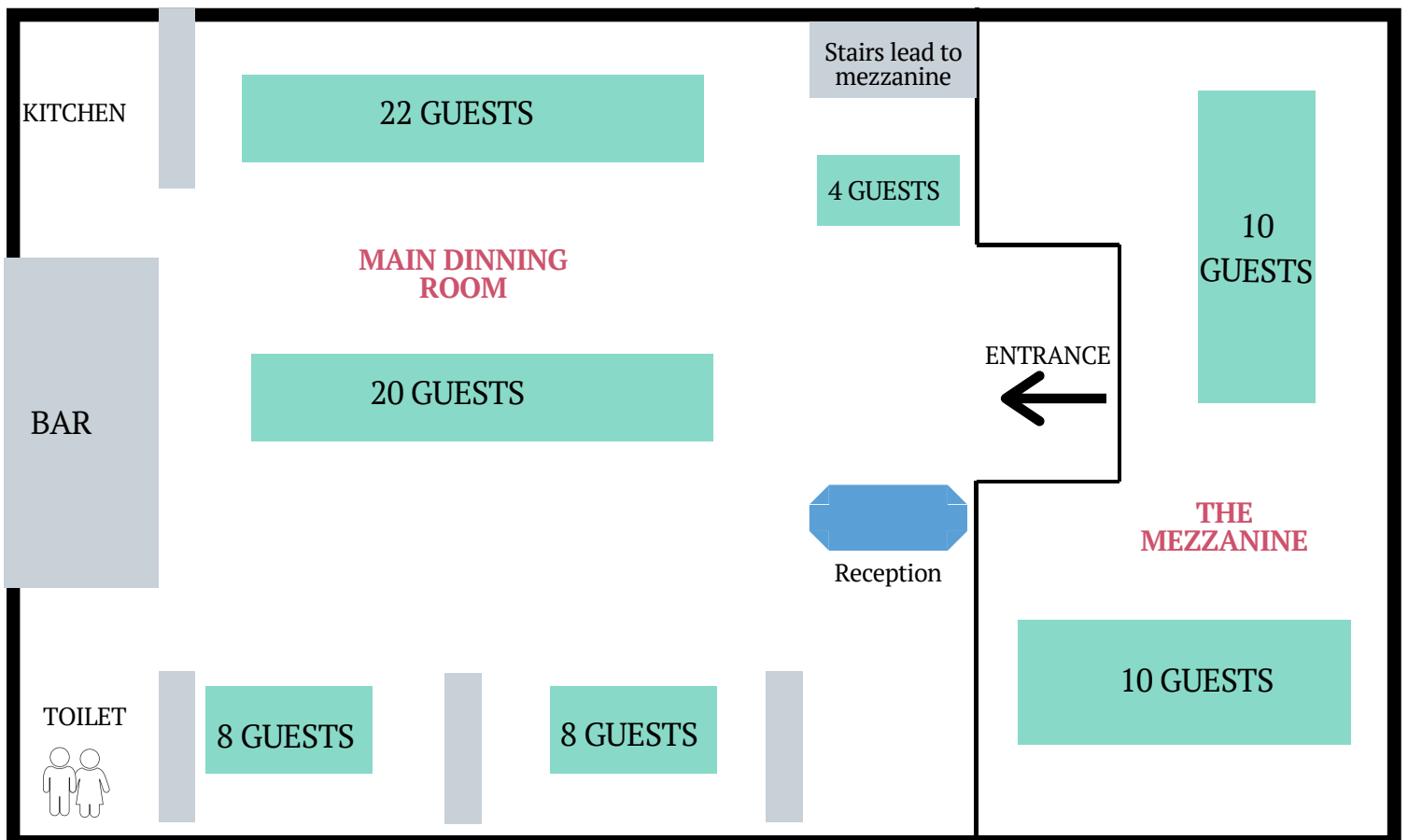



THE MAIN ROOM





THE MEZZANINE



THE YARD AREA

